

Accessory	Application	Publications No.
<b>SPLASH GUARDS</b>	<b>2005 RL</b>	<b>BII 27033</b>
		Issue Date
		<b>SEP 2004</b>

**PARTS LIST**

Left front splash guard

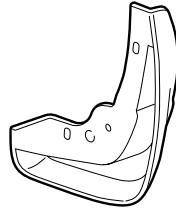

Right front splash guard

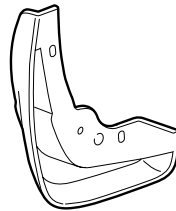

Left rear splash guard



Right rear splash guard



4 Spring nuts



4 Self-tapping screws



**TOOL REQUIRED**

Stubby Phillips screwdriver

90° Phillips screwdriver

**INSTALLATION**

**NOTE:**

- These instructions show the left splash guard being installed. The same procedure applies to installing the right splash guard.
- Make sure the area to be covered is clean, and waxed.

**Installing the Front Splash Guards**

1. Turn the steering wheel all the way counterclockwise.
2. Remove and retain the three self-tapping screws that fasten the left front inner fender to the vehicle.

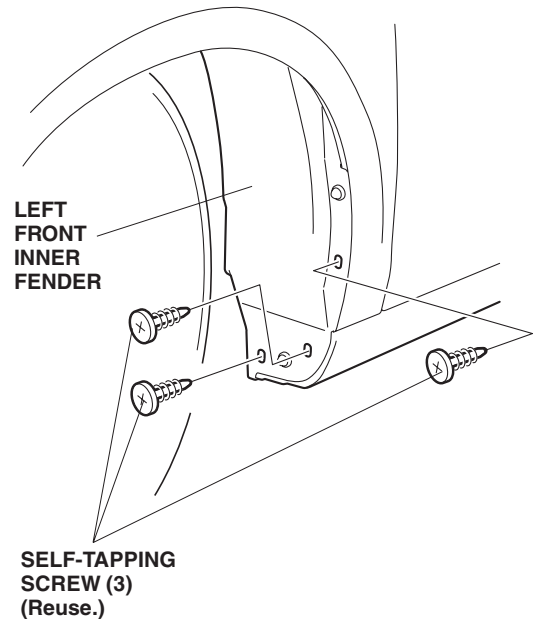

- Position the left front splash guard on the left front inner fender, and reinstall the three self-tapping screws you removed. Tighten the three self-tapping screws in the order shown.

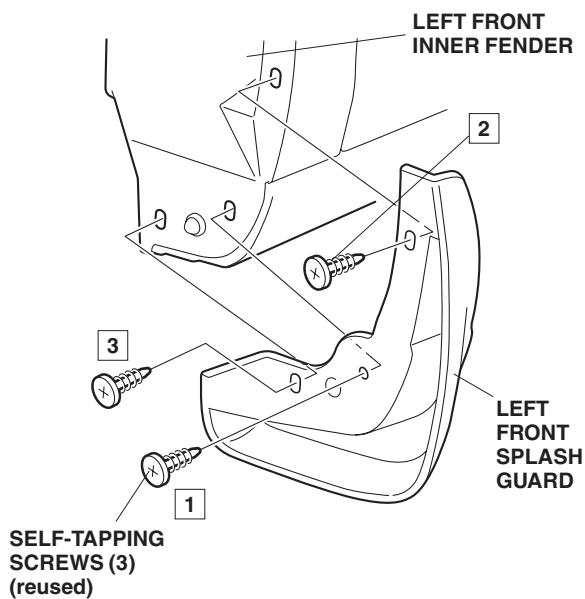

- Turn the steering wheel all the way clockwise, and repeat steps 2 and 3 to install the right front splash guard.

## Installing the Rear Splash Guards

- Remove and retain the one self-tapping screw that secures the left rear inner fender to the vehicle.

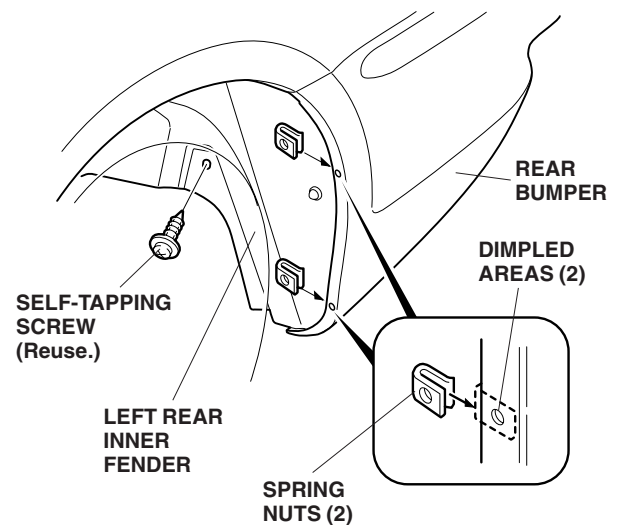

- Slide two spring nuts over the dimpled areas of the rear bumper.
- Position the left rear splash guard on the rear bumper and inner fender, and install the one self-tapping screw removed in step 5 and the two self-tapping screws provided. Tighten the three self-tapping screws in the order shown.

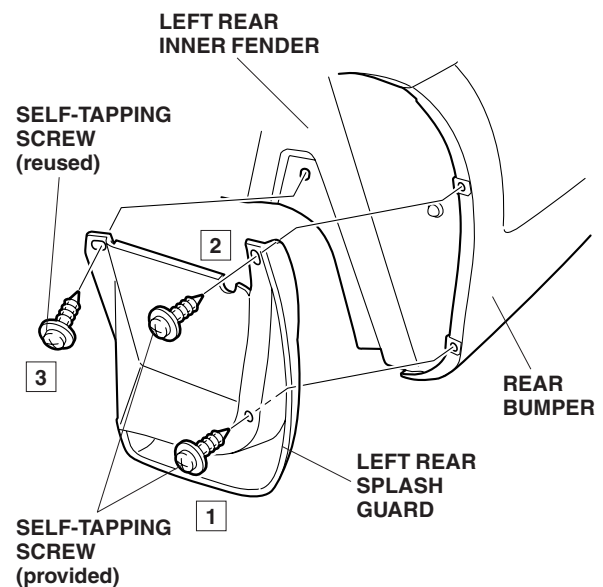

- Repeat steps 5 thru 7 to install the right rear splash guard.