

Accessory	Application	Publications No.
<b>SPORTS SUSPENSION</b>	<b>2005 RL</b>	<b>BII 27034</b>
		Issue Date
		<b>MAY 2005</b>

**PARTS LIST**

Right front damper assembly

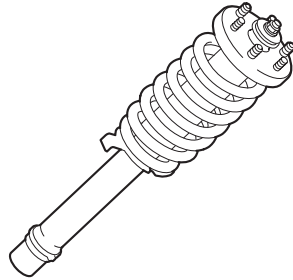

Left front damper assembly

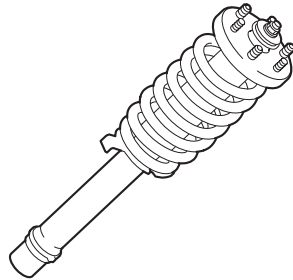

Right rear damper

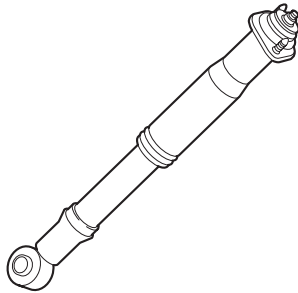

Left rear damper

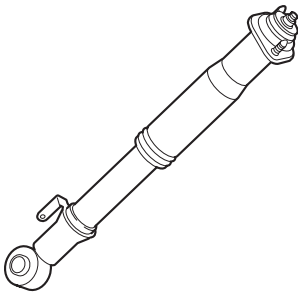

2 Springs

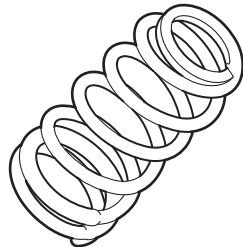

2 Self-locking nuts, 12 mm



4 Self-locking nuts, 10 mm



Special nut, 6 mm



2 Split pins

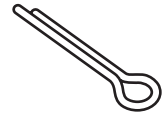

Owner's manual

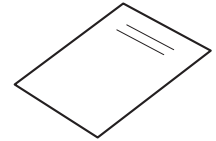

**TOOLS AND SUPPLIES REQUIRED**

14 mm and 17 mm Combination wrenches

14 mm and 17 mm Sockets

14 mm Crows foot

Hex wrench

Ratchet

Isopropyl alcohol

**INSTALLATION**

**Customer Information:** The information in this installation instruction is intended for use only by skilled technicians who have the proper tools, equipment, and training to correctly and safely add equipment to your vehicle. These procedures should not be attempted by "do-it-yourselfers."

**NOTE:**

- Place the car on a firm, level surface.
- Inflate the tires to the specified air pressure.
- Observe the procedure and safety notes and precautions described in the applicable Service Manual.
- Install the right and left dampers in the proper positions. The damper marked R goes on the right side; the damper marked L goes on the left side.

- These instructions show the left damper being installed; repeat this procedure to install the right damper.

### Replacing the Front Damper

1. Remove the covers in the engine component.

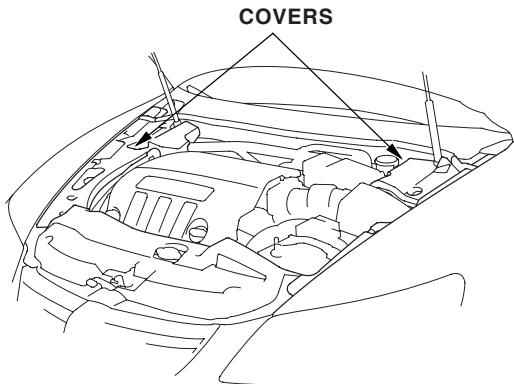

2. With the vehicle on a rack, remove the front wheel, taking care not to scratch the caliper.
3. Disconnect the AFS linkage from the damper.
4. While pushing the lower arm down, remove the damper fork from the damper and lower arm.

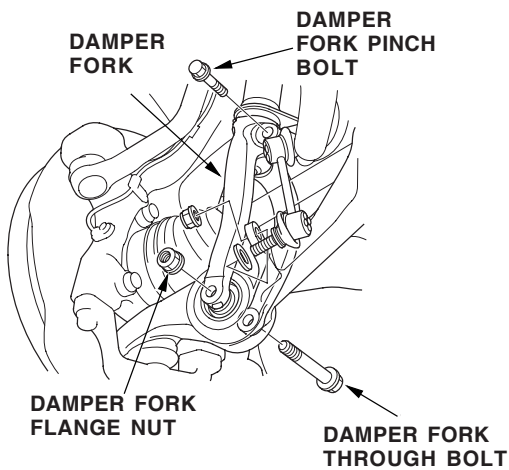

5. Disconnect the stabilizer link from the lower arm.
6. Remove the 8 mm flange nuts and the 10 mm flange nuts from the top of the damper.

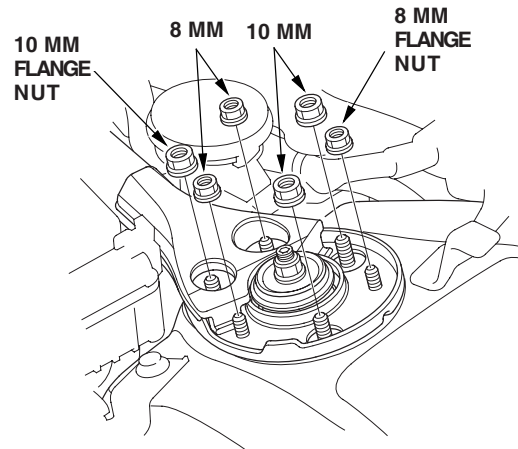

7. Remove the front damper assembly.

#### NOTE:

- To provide clearance to remove the damper assembly, rotate the steering wheel clockwise until it stops.
- Be careful not to damage the aluminum parts. It may weaken the suspension.

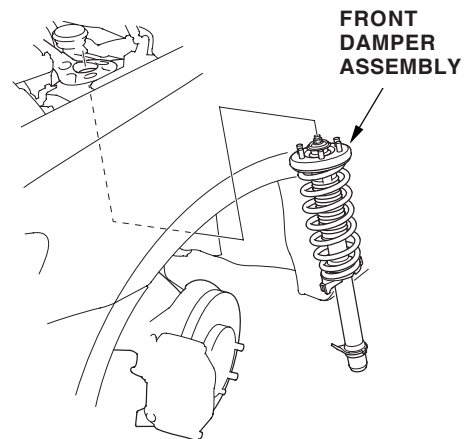

## Installing the Front Damper

8. Position the new front damper assembly in the body with the aligning tab facing inside.

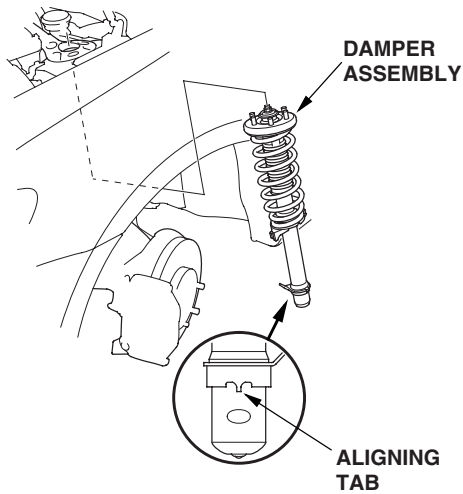

9. Loosely install the 8 mm flange nuts and the 10 mm flange nuts on the top of the damper.

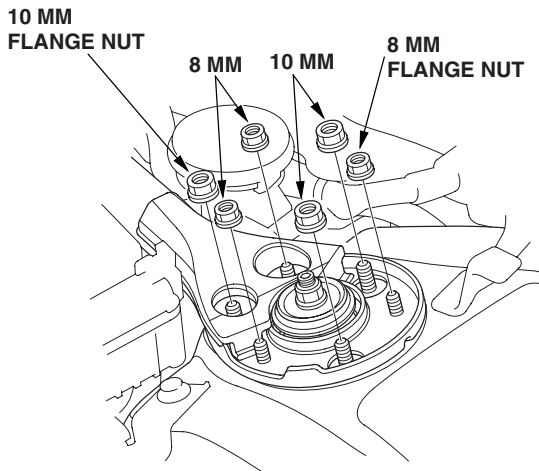

10. Install the damper fork over the driveshaft and onto the lower arm while pushing the lower arm down. Install the front damper in the damper fork so the aligning tab is aligned with the slot in the damper fork.

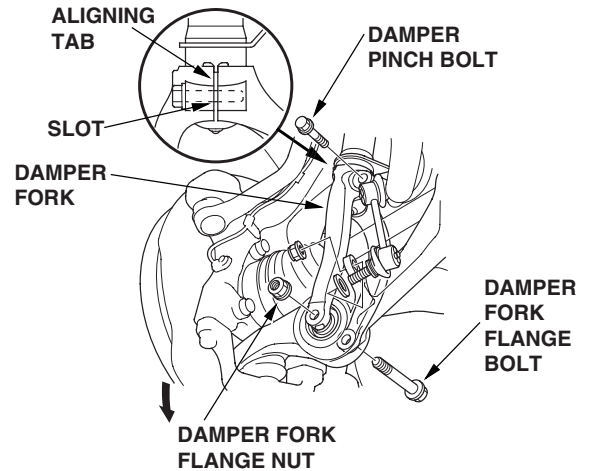

11. Loosely install the damper pinch bolt into the damper fork.
  12. Install the flange bolt to the damper fork and lower arm, then lightly tighten the new damper fork mounting nut.
- NOTE: Use a new damper fork mounting nut on reassembly.
13. Reconnect the stabilizer link to the lower arm.
  14. Place the floor jack under the lower arm, and raise the suspension to load it with the vehicle's weight.
  15. Tighten the flange nuts on the top of the damper to the specified torque values.
  16. Tighten the damper pinch bolt and the flange nut on the damper fork to the specified torque value.
  17. Connect the AFS linkage to the damper, using a new self-locking nut from the kit.
  18. Clean the mating surfaces of the brake disc and the inside of the wheel, then install the front wheel.
  19. Repeat steps 2 thru 18 to install the right damper

## Replacing the Rear Damper

20. Remove the rear wheel.
21. Disconnect the AFS linkage from the damper.

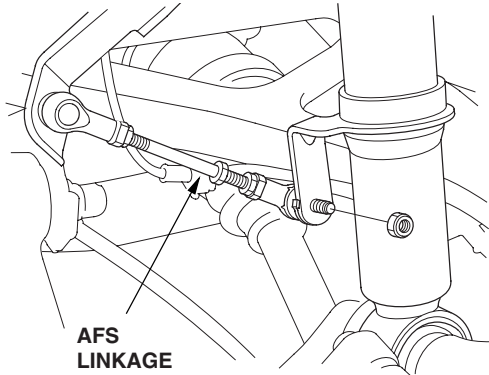

22. Remove the rear shelf.
23. Remove the two flange nuts from the top of the rear damper.

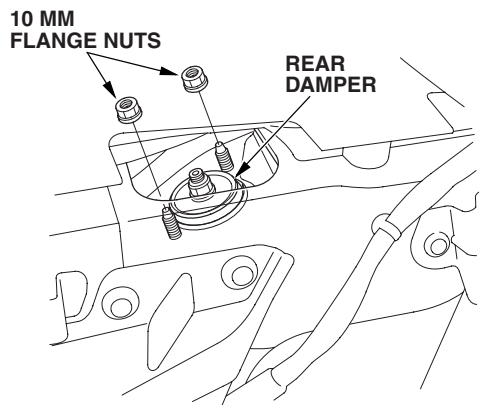

24. Remove the damper lower mounting bolt from the knuckle.

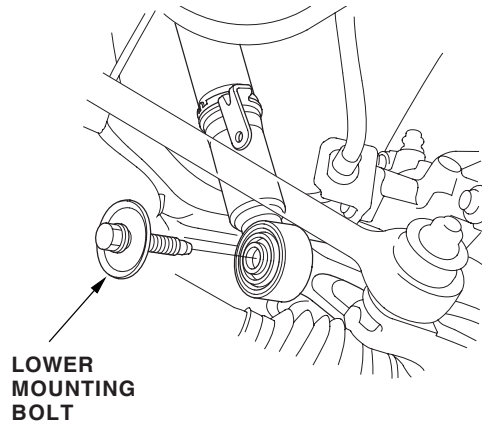

25. Remove the damper from the vehicle.

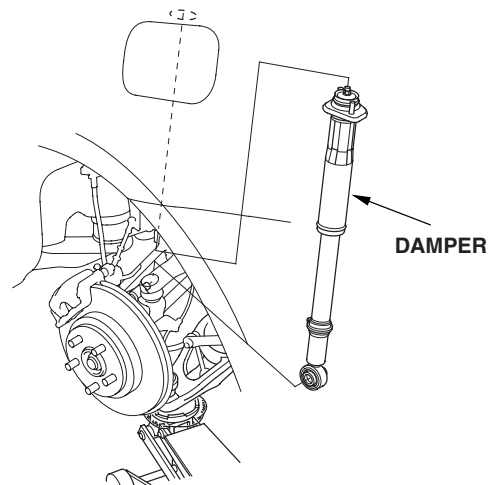

26. Compress the damper by hand, and move it into position.

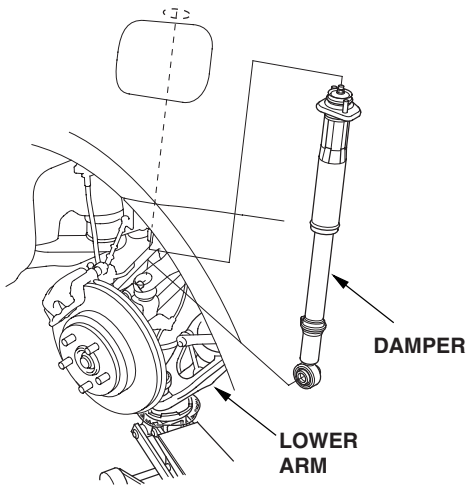

27. Loosely tighten the damper lower mounting bolt.

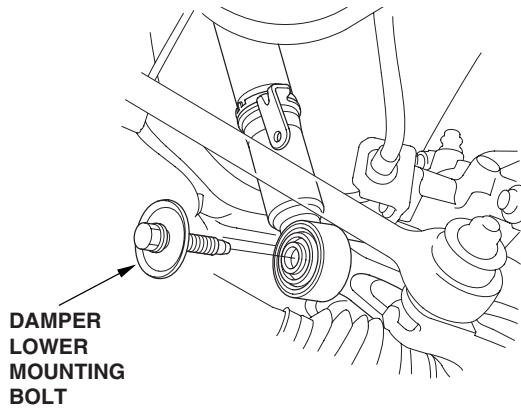

28. Loosely install the flange nuts.

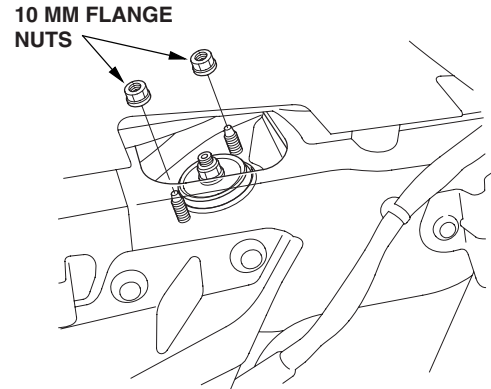

29. Raise the rear suspension with a floor jack to load it with the vehicle's weight.

30. Tighten the flange nuts and the damper lower mounting bolt to the specified torque value.

31. Connect the AFS linkage to the damper with the self-locking nut.

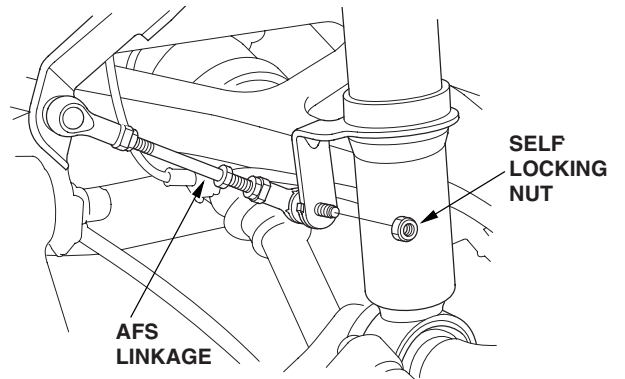

32. Repeat steps 20 thru 31 to install the right rear damper.

33. Place a floor jack at the connecting point of the lower arm and the stabilizer link.
34. Remove the cotter pin from the lower arm ball joint, and loosen the nut.

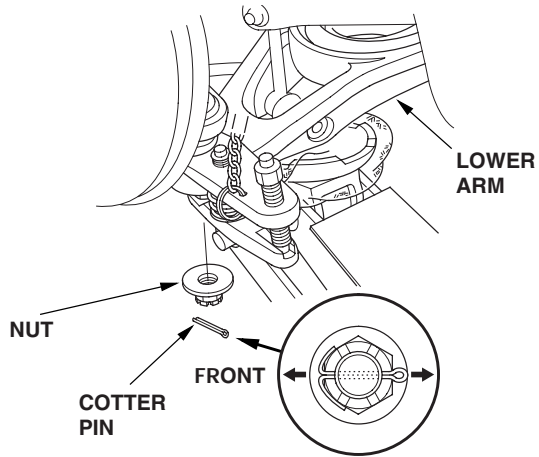

35. Disconnect the lower arm ball joint from the knuckle using the special tool.
36. Lower the floor jack gradually.
37. Remove the spring, bump stop, and lower spring seat.

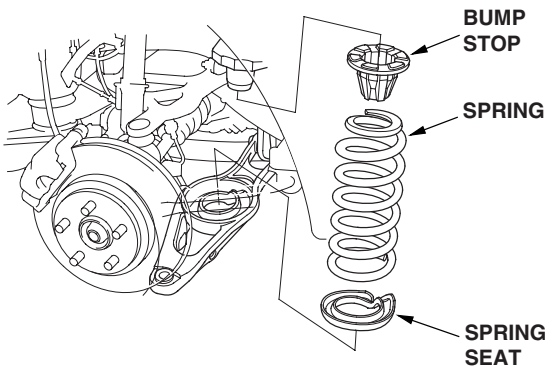

38. Install the bump stop, spring, and lower spring seat.

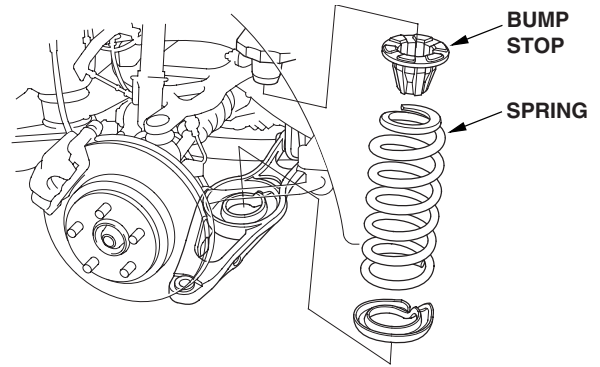

39. Align the bottom of the spring, the stepped part of the lower spring seat, and the lower arm.

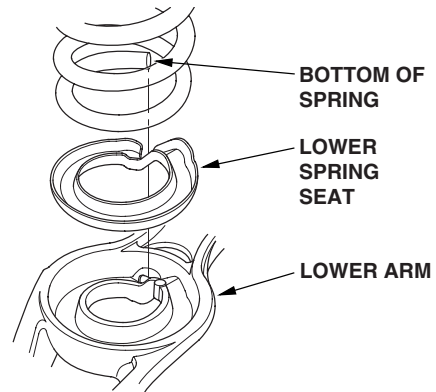

40. Place the floor jack at the connecting point of the lower arm and the stabilizer link.

41. Raise the jack slowly until you can align the bolt hole in the lower arm and the knuckle ball joint pin, then loosely install the castle nut.

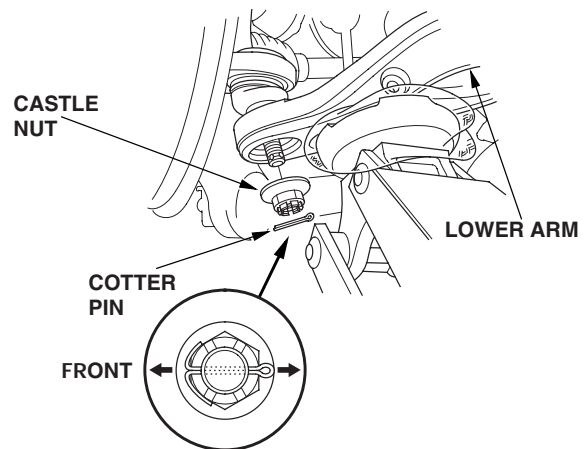

42. Install the stabilizer link on the lower arm with the washer and the new self-locking nut, and lightly tighten them.
43. Raise the rear suspension with a floor jack to load it with the vehicle's weight.
44. Tighten the castle nut and self-locking nut to the specified torque value.

**NOTE:**

- Torque the castle nut to the lower torque specification, then tighten it only far enough to align the slot with the ball joint pin hole. Do not align the castle nut by loosening it.
  - Insert a new cotter pin into the ball joint pin from the rear to the front of the vehicle, and bend its end as shown.
45. Reinstall the wheels and torque the wheel nuts to 127 N·m (94 lb-ft)
  46. Check the rear wheel alignment, and adjust it if necessary.

	Front	Rear
Camber	neg -0° 08'±30'	neg -1° 15'±30'
Caster	2° 10'±30'	N/A
Toe	0±2mm	2±2mm

### Installing the A-Spec Emblem

47. Using the lower right corner of the trunk lid as a guide, temporarily position A-spec emblem on the trunk lid 42 mm (1 5/8 inches) from the bottom, and 70 mm (2 3/4 inches) from the side.
48. Using a shop towel dampened with isopropyl alcohol, clean the body surface where the exterior emblem will attach.

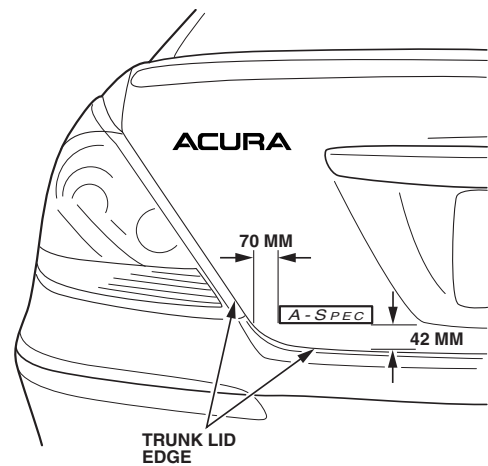

49. Remove the adhesive backing from the emblem, and position the emblem on the trunk lid, 42 mm (2 3/4 in) from the bottom, and 70 mm (1 5/8 in) from the right edge of the trunk lid.
50. Firmly press the emblem into position and hold it for 30 seconds.
51. Give a completed copy of the certification page to your customer, and keep one copy for your records.



## Installation Certification

I certify that an Acura A-Spec sports suspension has been installed on this vehicle following Acura specifications:

---

VIN

---

Technician

Date

---

Dealer Number

Dealer Sales Copy

Customer Copy

AHM copy