



ACURA INSTALLATION INSTRUCTIONS

Accessory	Application	Publications No.
ACURA MUSIC LINK (FOR iPod®)	2006 RL	BII 31183-34929
		Issue Date
		MARCH 2007

PARTS LIST

Attachment Kit (sold separately)
P/N 08A28-1H1-800

4 Cushion tapes

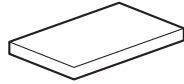

Holder cushion

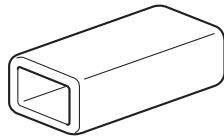

Grommet



8 Wire ties

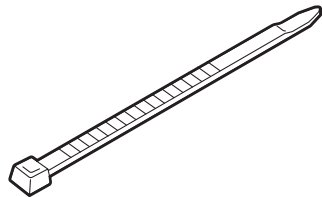

2 Long wire ties

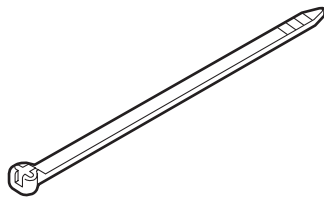

Music Link Adapter Kit (sold separately)
P/N 08A28-1H2-100

Music Link adapter unit

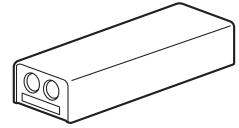

Bus cable

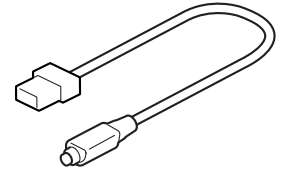

Music Link harness

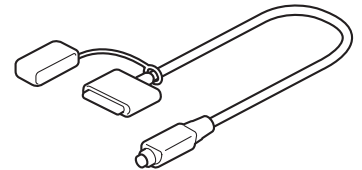

CD-ROM
(for home computer use only)

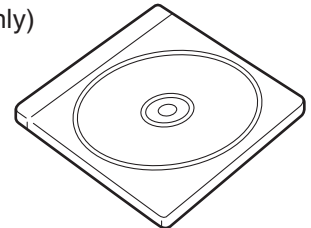

Quick reference guide

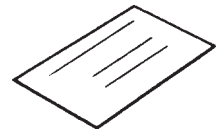

Y-Harness Adapter (sold separately)
P/N 08A31-0F1-000

Y-harness adapter

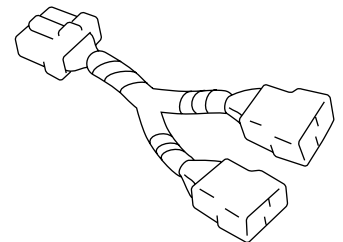

TOOLS AND SUPPLIES REQUIRED

- #2 Phillips screwdriver
- Flat-tip screwdriver
- Diagonal cutters
- Scissors
- Ratchet
- 10 mm Socket
- 10 mm Combination wrench
- Drill motor
- 3 mm Drill bit
- 20 mm Hole saw
- Shop towel
- Pushpin
- Eye protection
- Isopropyl alcohol
- Electrical tape

Illustration of the Music Link System Installed on the Vehicle

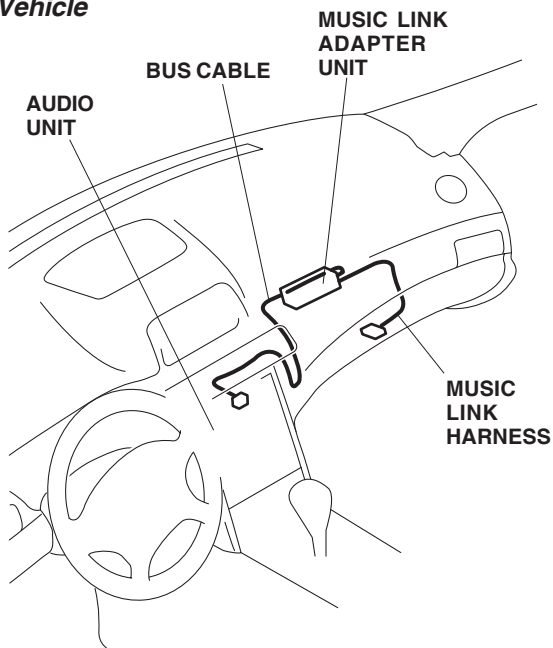

INSTALLATION

Client Information: The information in this installation instruction is intended for use only by skilled technicians who have the proper tools, equipment, and training to correctly and safely add equipment to your vehicle. These procedures should not be attempted by “do-it-yourselfers.”

1. Make sure you have the anti-theft code for the radio, then write down the frequencies for the preset buttons.
2. Disconnect the negative cable from the battery.

3. Remove the three clips from the glove box under cover, and pull the glove box under cover out toward you to remove the two pins.

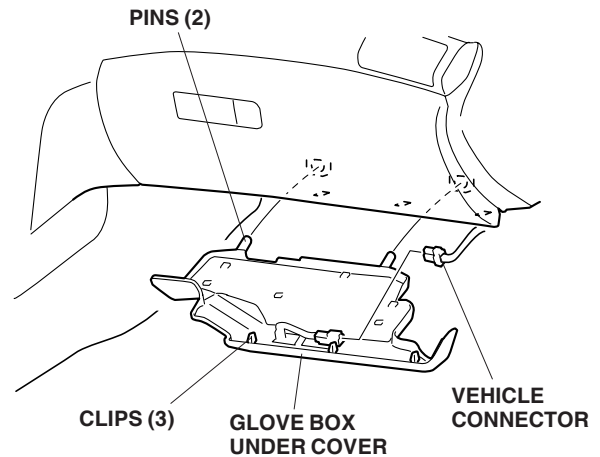

4. Remove the glove box under cover by unplugging the vehicle connector.
5. Open the glove box, and remove the cover as shown.

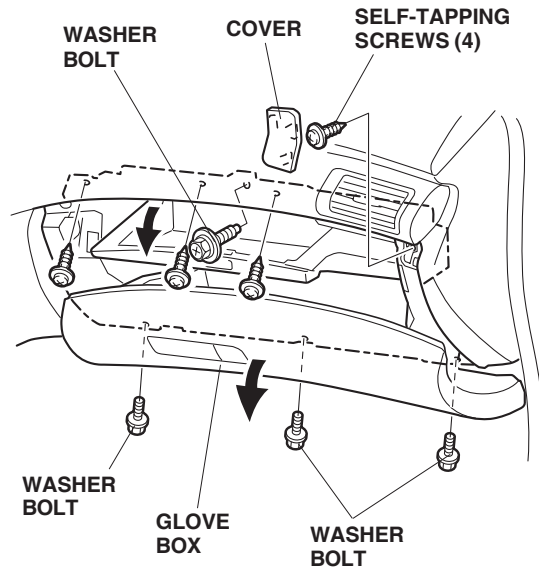

6. Remove the four self-tapping screws and four washer bolts.

- Pull down the glove box to remove the two clips and release the two retaining tabs.

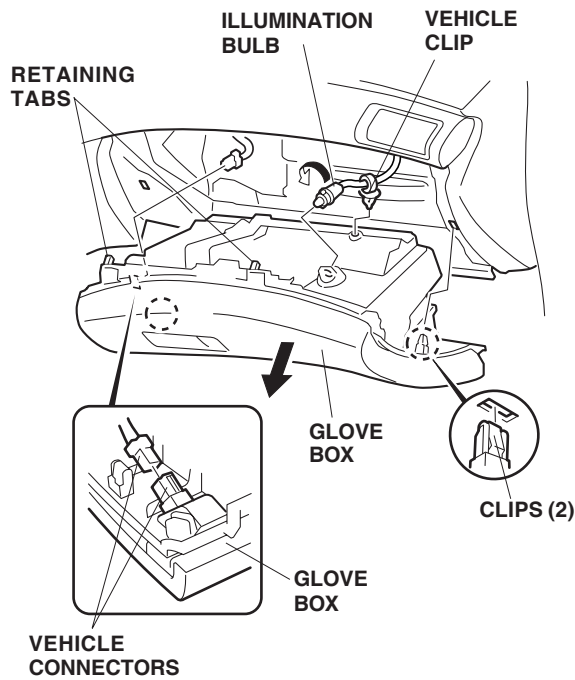

- Remove the glove box by removing the vehicle clip, illumination bulb, and unplugging the vehicle connector.
- With the parking brake applied, place the gear shift lever in the neutral position.

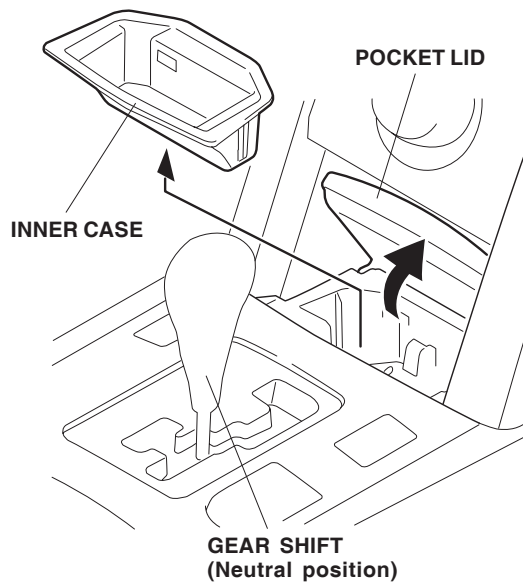

- Open the pocket lid, and remove the inner case.

- Remove the center console trim (four clips, the clip that secures the vehicle harness, and disconnect the vehicle connectors). The number of the vehicle connectors varies depending on the type of vehicle.

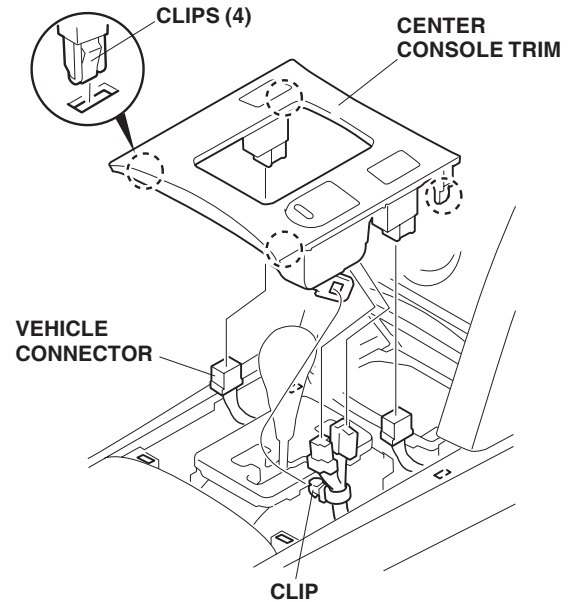

- Remove the two self-tapping screws from the pocket.

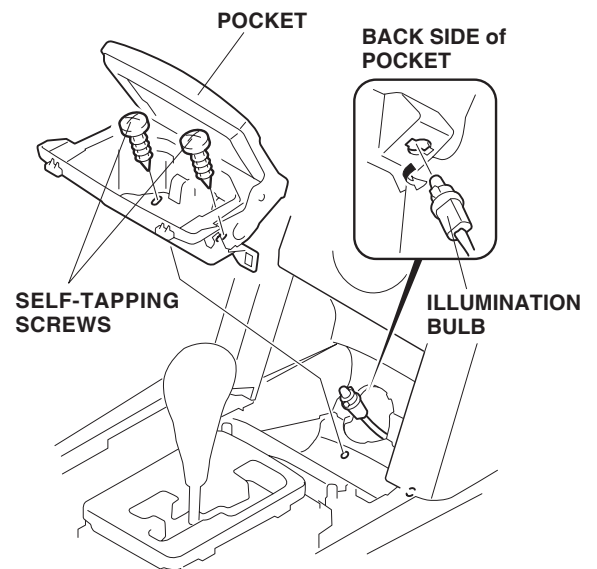

- Pry out the pocket, then remove the illumination bulb by twisting from the rear of the pocket. The illumination harness is short; take care not to pull it excessively. Remove the pocket.

14. Open the console lid. Pull the console trim out toward you to remove the two clips, then remove the console trim.

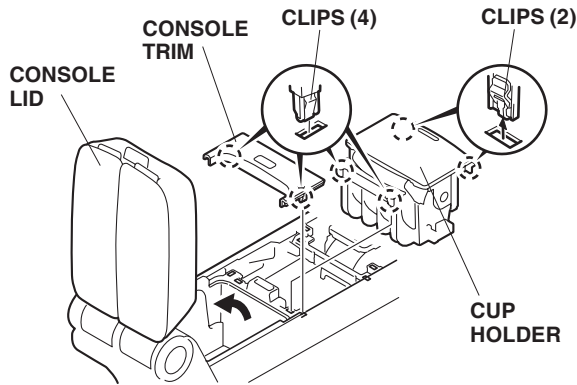

15. Pull the cup holder out toward you to remove the four clips, then remove the cup holder.
16. Remove the seven clips of the passenger's seat side console trim. Pull the passenger's seat side console trim toward the rear to remove the two pins, then remove the trim.

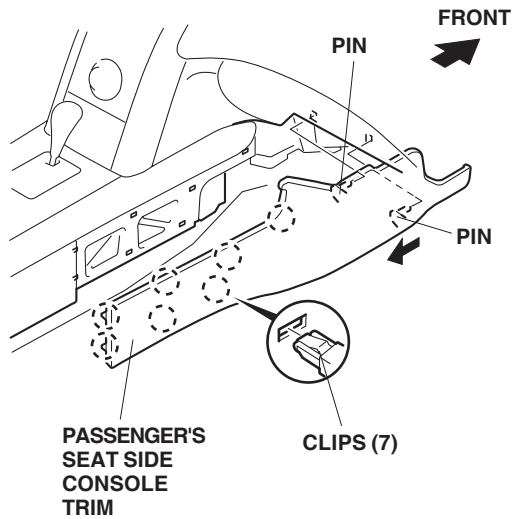

17. Using the same procedure, remove the driver's seat side console trim.

18. Remove the console mat from inside the console box.

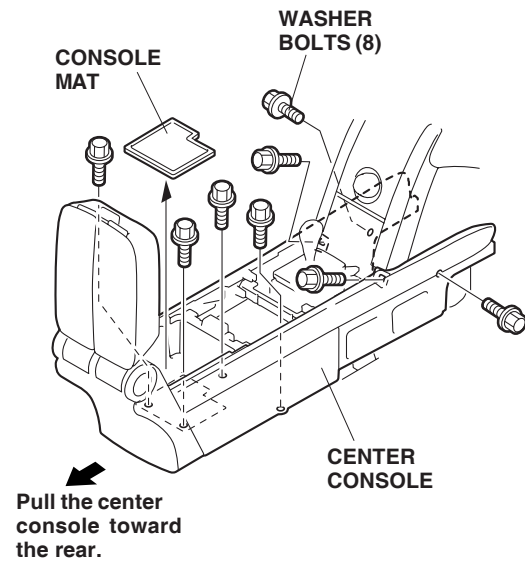

19. Remove the eight washer bolts from the center console, and pull the center console toward the rear.

20. Remove the right center panel trim by removing the three clips and the one retaining tab.

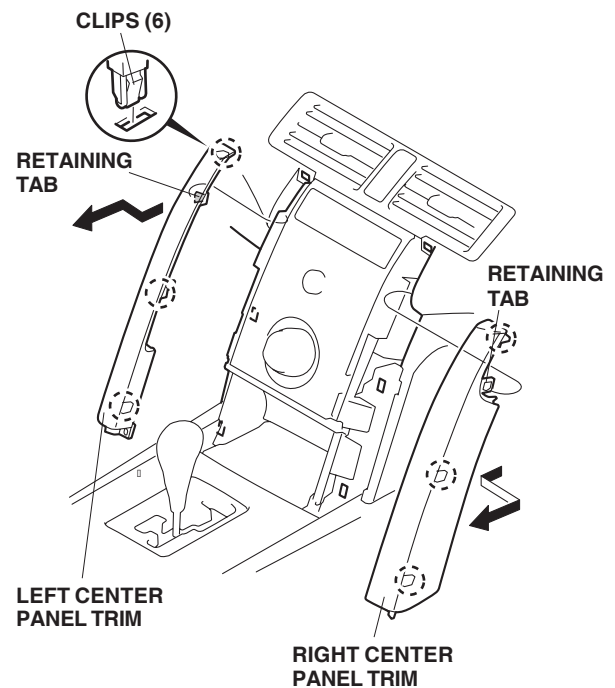

21. Using the same procedure, remove the left center panel trim.

22. Remove the inner trim (two self-tapping screws).

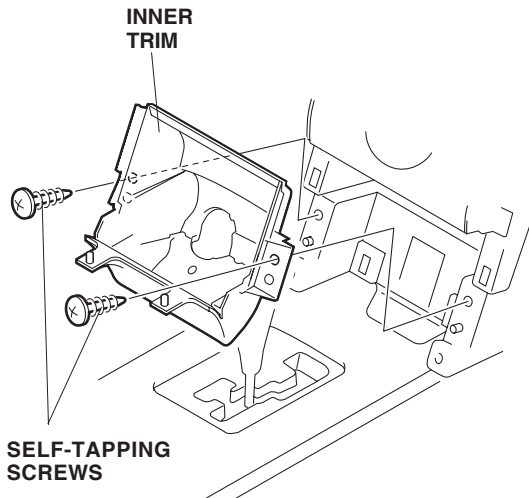

23. Pull the center module out toward you to remove the two flange bolts and four washer bolts from the center module.

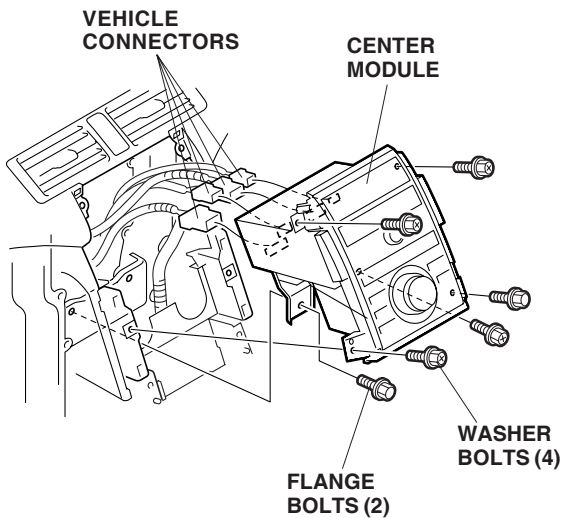

24. Remove the center module by unplugging the vehicle connectors.

25. Route the DIN connector end of the bus cable from the center module opening to the glove box opening.

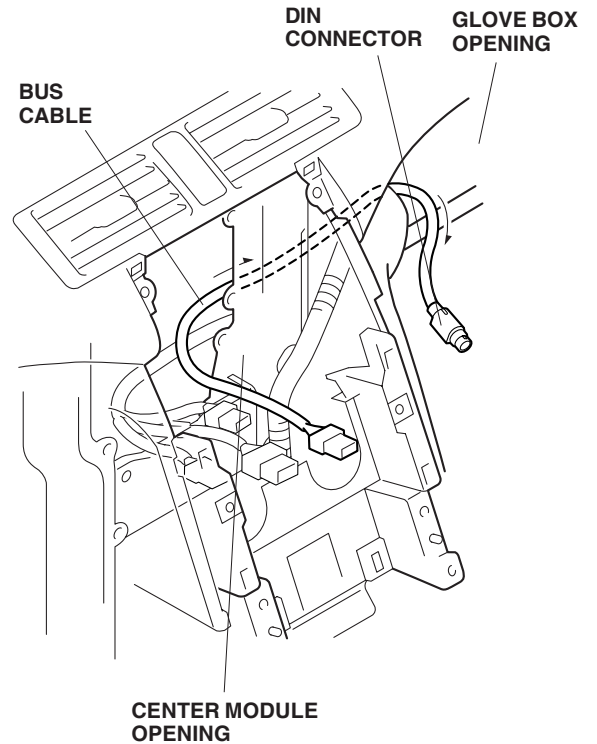

26. Connect the bus cable 14-pin connector and the vehicle 14-pin connector to the Y-harness adapter 14-pin connectors.

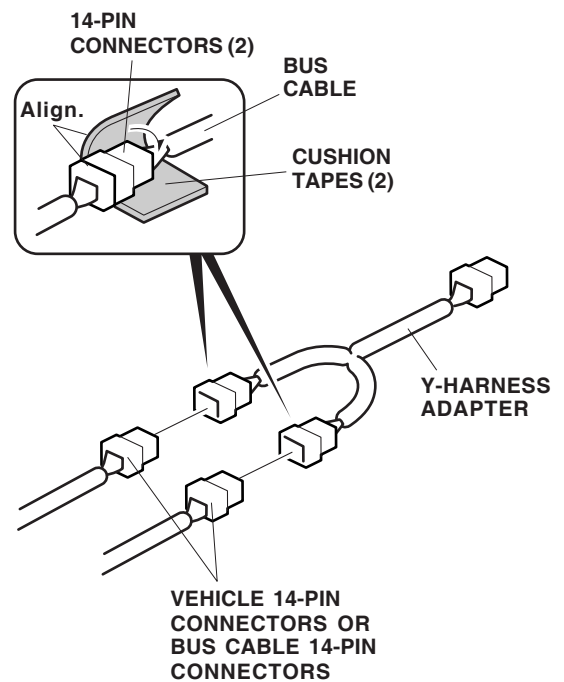

27. Attach the two cushion tapes to the Y-harness adapter 14-pin connectors you just connected.

28. Align the Y-harness adapter 14-pin connector with the vehicle 20-pin connector, and secure the Y-harness adapter and the bus cable to the vehicle harness with two wire ties as shown.

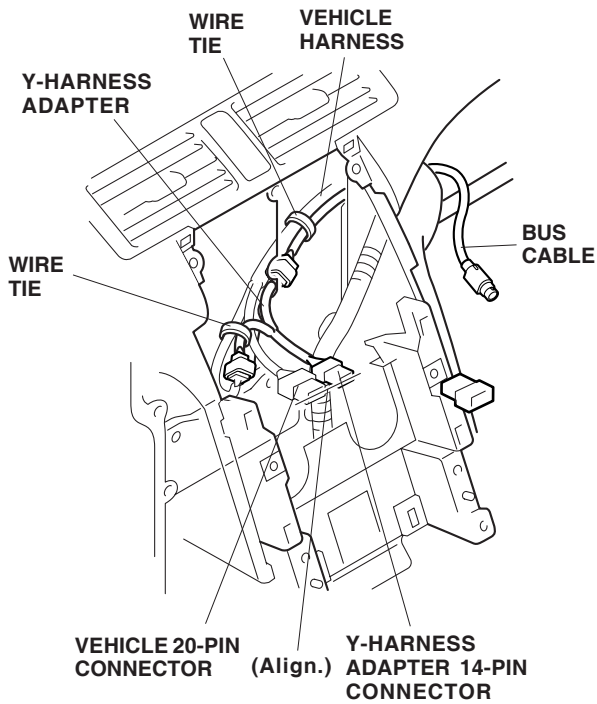

29. Get the Music Link harness. Measure and mark the Music Link harness at the location shown using a felt-tip pen.

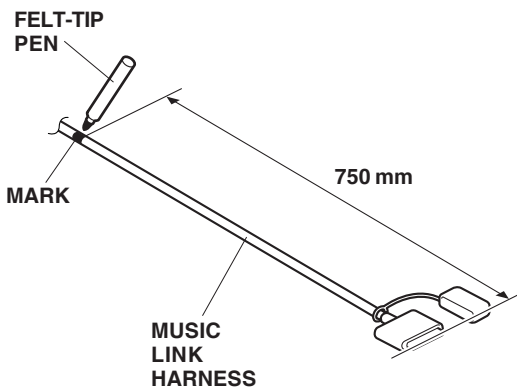

30. To prevent damage, wrap electrical tape around the drill bit at a point about 30 mm away from the tip. While wearing eye protection, drill a 20 mm hole through the marked location. Remove all burrs from the drilled hole.

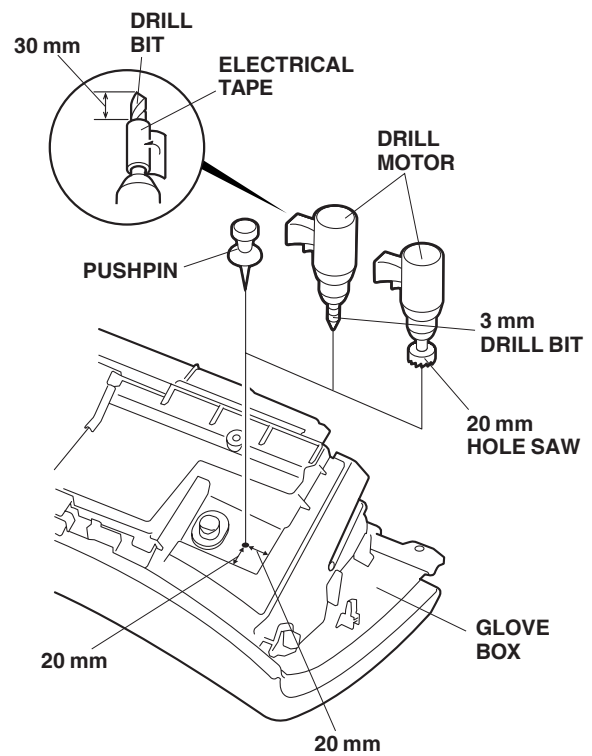

31. Route the Music Link harness DIN connector into the 20 mm hole in the direction shown.

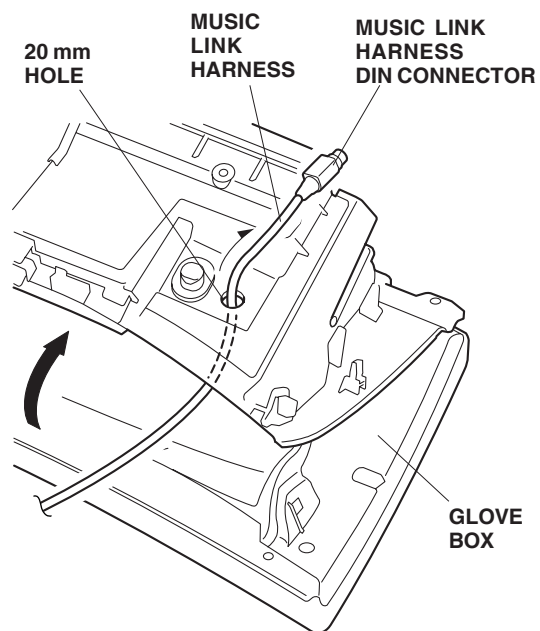

32. Using a utility knife, cut the grommet as shown. Attach the grommet to the Music Link harness, and seat the grommet into the 20 mm hole.

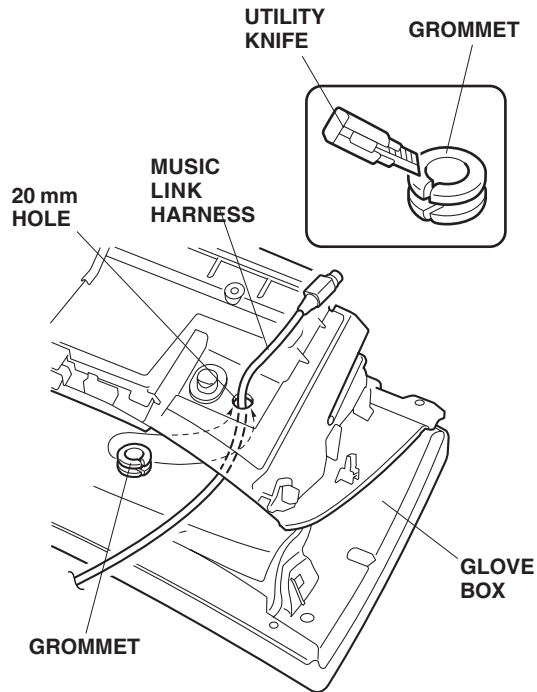

33. Clean the vehicle pipe and vehicle bracket with isopropyl alcohol where the cushion tapes will attach. Attach a cushion tape to the vehicle pipe.

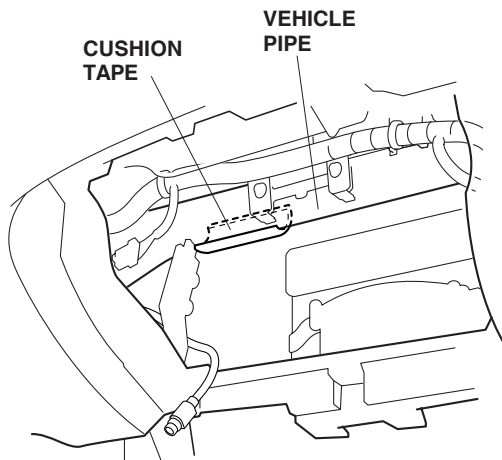

34. Insert the Music Link adapter unit into the unit cushion.

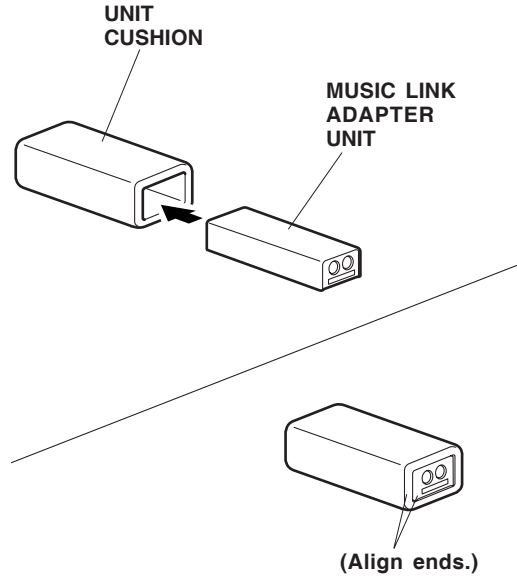

35. Route the Music Link harness through the glove box opening and connect the Music Link harness DIN connector (White) to the Music Link adapter assembly. Note the location of the connector and the terminals.

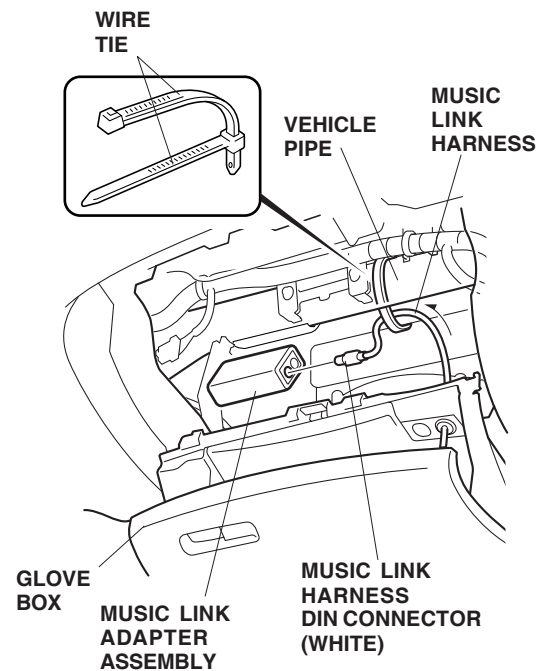

36. Secure the Music Link harness to the vehicle pipe with the two wire ties.

37. Loosely attach the Music Link adapter assembly to the vehicle pipe with two long wire ties.

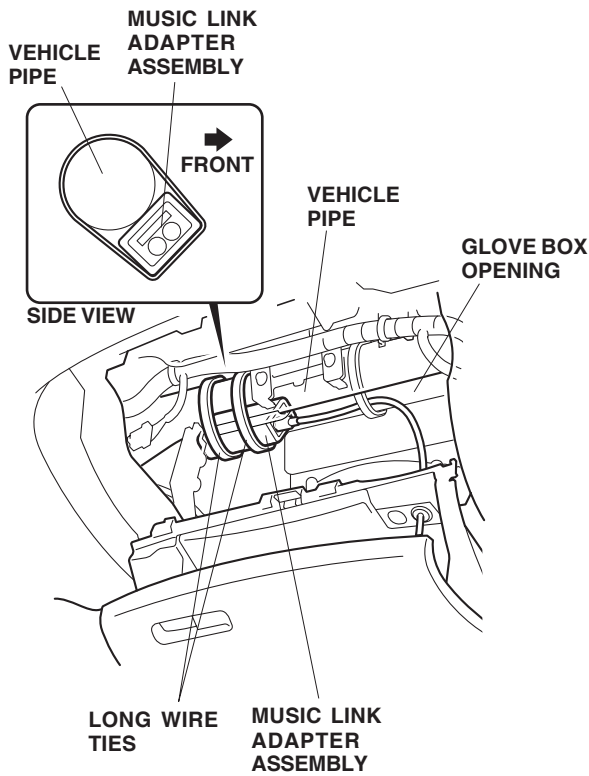

38. Route the bus cable through the two long wire ties loosely attached, and connect the bus cable DIN connector (Black) to the Music Link adapter assembly. Note the location of the connector and the terminals.

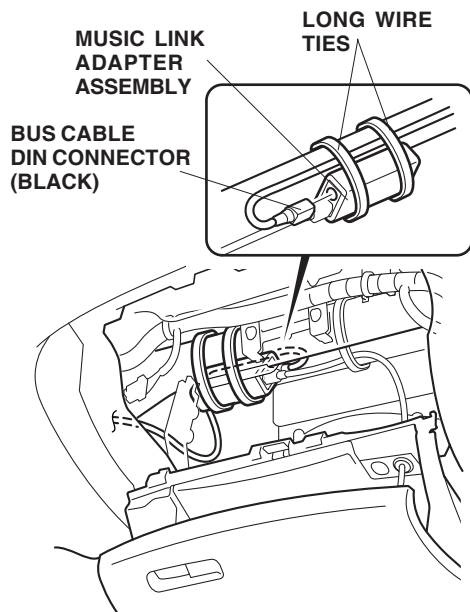

39. Secure the two long wire ties.

40. Bundle up the excess bus cable, and secure them to the vehicle harness with two wire ties.

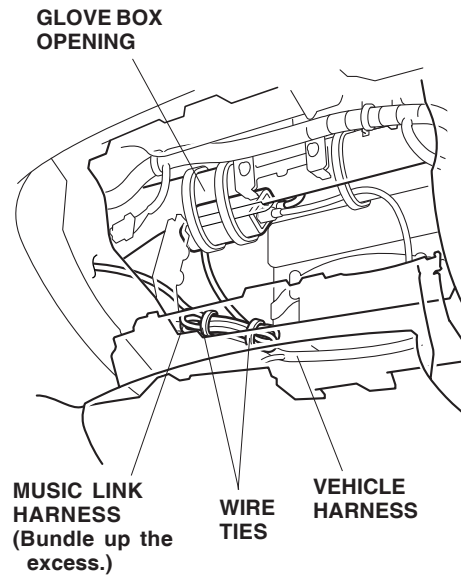

41. Bundle up the excess Music Link harness, and secure it to the vehicle harness with two wire ties. Align the mark you made in step 29 with the wire tie.

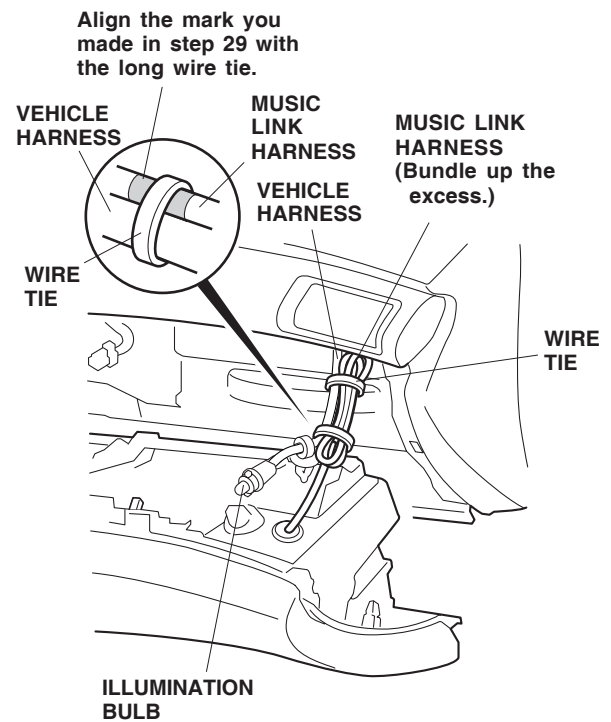

42. Reinstall the glove box.

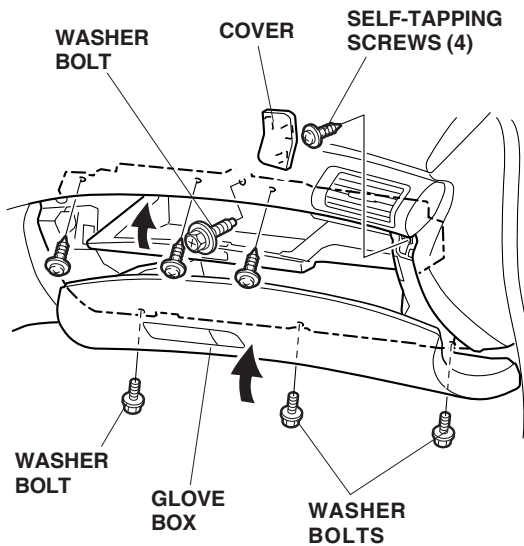
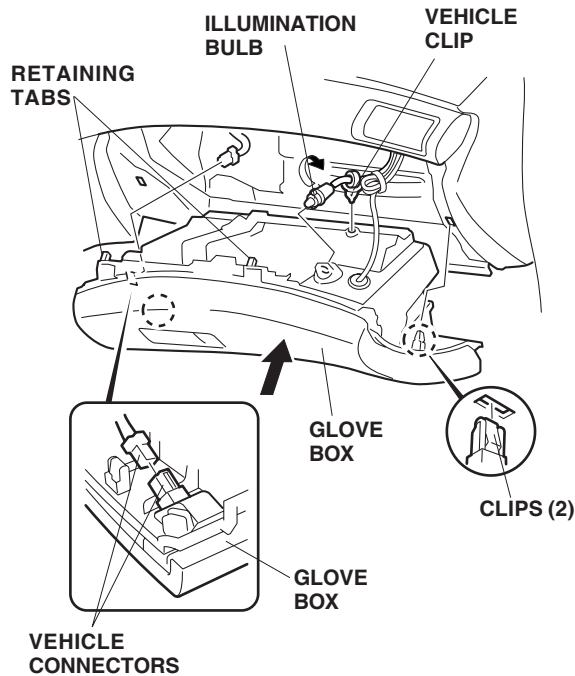

43. Connect the vehicle connectors and bus cable 14-pin connector (or Y-harness adapter 14-pin connector) to the center module, and reinstall the center module.

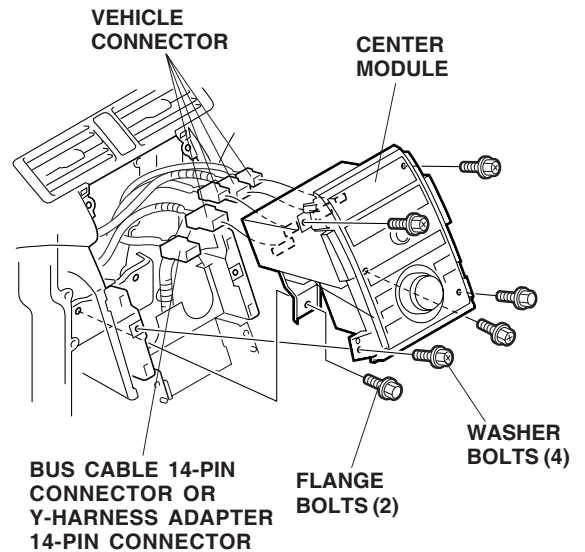

44. Check that all wire harnesses are routed properly and all connectors are plugged in.
45. Reconnect the negative cable to the battery.
46. Enter the client's radio anti-theft code. Then reset the radio station presets and the clock.
47. Reinstall all removed parts.
48. Turn the audio unit ON. Check that CD EJECT, or CD4 EJECT is shown on the audio display while in the DISC mode. The Navigation screen will display "Extension" when in Music Link mode. (The Music Link is recognized as an accessory CD changer.)

NOTE: Whenever the battery is disconnected, the driver's AUTO function is disable.

49. Start the engine. Push down on the driver's window switch until the window is fully open.
50. Pull up on the driver's window switch fully to close the window completely, then hold the switch for 2 seconds or more.
51. Test the window AUTO function.